

Patient Leaflet According to the Pharmacists' Regulations (Preparations) – 1986

This medicine is sold with a doctor's prescription only

Rafassal 1 gram Enema

Rafassal 4 gram Enema

Active ingredient:

Each Rafassal 1 gram Enema contains: mesalazine 1 gram.

Each Rafassal 4 gram Enema contains: mesalazine 4 gram.

The active ingredient is also called mesalamine or 5-aminosalicylic acid.

For the list of the additional ingredients, see section 6. See also 'Important information about some of the medicine's ingredients' in section 2.

Read the leaflet carefully in its entirety before using the medicine.

This leaflet contains concise information about the medicine. If you have any further questions, please refer to your doctor or pharmacist.

This medicine has been prescribed to treat your illness. Do not pass it on to others. It may harm them, even if it seems to you that their illness is similar to yours.

1. What is the medicine intended for?

The medicine is intended for treatment and prevention of ulcerative colitis (inflammation of the large intestine) and Crohn's disease.

Therapeutic group: anti-inflammatory medicine from the salicylate group.

2. Before using the medicine

Do not use the medicine if:

- You are sensitive (allergic) to the active ingredient, salicylic acid, salicylates such as Aspirin or to any of the additional ingredients the medicine contains (for a list of the additional ingredients, see section 6).
- You suffer from severe impairment of liver or kidney function.

Special warnings regarding the use of this medicine:

Before (and during) the treatment with the medicine, tell your doctor if:

- You suffer or have suffered in the past from lung problems, particularly if you suffer from asthma (bronchial).
- You suffer or have suffered in the past from allergy to a substance named sulphasalazine, which is a substance related to the active ingredient mesalazine. In such a case, close medical supervision will be required. (If acute symptoms of intolerance appear, for instance abdominal pain or cramps, fever, severe headache, rash - stop the treatment immediately).
- You suffer or have suffered in the past from liver problems.
- You suffer or have suffered in the past from kidney problems.
- You have ever developed a severe skin rash or skin peeling, blistering and/or mouth sores after using medicines containing mesalazine (the active ingredient in Rafassal).

Additional warnings:

- During the treatment with this medicine your doctor may decide to keep you under close medical supervision (See also 'Tests and follow-up').
- Kidney stones may develop with use of the medicine. Symptoms may include pain in sides of abdomen and blood in urine. Take care to drink a sufficient amount of liquids during treatment with the medicine.

- Serious skin reactions including Stevens-Johnson syndrome and toxic epidermal necrolysis have been reported in association with mesalazine treatment. Stop using the medicine and refer to the doctor immediately if you notice these serious skin reactions. (See detailed symptoms described in section 4 'Side effects').

Children and adolescents: there is little experience in use with children. The use in children and adolescents aged 6 to 18 years is as instructed by the doctor and will be determined according to their condition and body weight.

Tests and follow up: before and during the treatment you may need to undergo blood and urine tests, as well as liver and kidney function tests.

Drug interactions: If you are taking, or have recently taken any other medicines, including non-prescription medicines and nutritional supplements, please tell your doctor or pharmacist. Especially inform your doctor or pharmacist if you are taking the following medicines (it should be noted that the following list indicates the active ingredients in the medicines. If you are unsure whether you are using one of these medicines, please consult with your doctor or pharmacist):

- Certain anticoagulant medicines (e.g. warfarin).
- Azathioprine, 6-mercaptopurine, thioguanine (medicines used to treat immune system disorders).

Pregnancy and breastfeeding:

If you are pregnant, think you are pregnant, are planning a pregnancy or if you are breastfeeding, consult your doctor before using the medicine.

- **Pregnancy:** there is insufficient information on the use of Rafassal in pregnant women. Use of Rafassal during pregnancy will be only upon the decision and instruction of your doctor.
- **Breastfeeding:** there is insufficient information on the use of Rafassal in breastfeeding women. The medicine passes into the breast milk. There may be hypersensitivity reactions such as diarrhea in the breastfed baby. Therefore, the use of Rafassal will be only upon the decision and instruction of your doctor. If your doctor allowed you to breastfeed, and the baby develops diarrhea, stop the breastfeeding.

Driving and operating machinery: The use of this medicine is not expected to affect your ability to drive or operate machinery.

Important information about some of the medicine's ingredients:

The enema contains the preservative sodium benzoate (60 mg per bottle), which may cause local irritation.

The enema contains potassium metabisulfite, which may cause, rarely, severe hypersensitivity reactions and bronchospasm.

3. How to use this medicine?

Always use according to the doctor's instructions. Check with your doctor or pharmacist if you are not sure about the dosage and the treatment regimen with the medicine.

The standard dosage is usually: the dosage, the treatment regimen and the treatment duration will be determined by the doctor only.

The dosage will be adjusted for you personally by the doctor, depending on your condition and your response to the treatment, which will be examined in periodic medical follow-ups and in periodic tests.

In the absence of any other instruction by the doctor, use the enema at bedtime.

Use this medicine at designated times as prescribed by your attending doctor.

Do not exceed the recommended dose.

Attention:

Not to be swallowed! This medicine is intended for use through the anus.

Shake well before use.

Manner of use: see instructions for use and illustrations in section 7.

If you accidentally used a higher dosage:

- If you accidentally used a higher dosage refer to a doctor who will advise you what to do.
- If a child or any person has accidentally swallowed the medicine, refer immediately to a doctor or to a hospital emergency room and bring the package of the medicine.

If you forgot to use the medicine: if you forgot to use the enema at the designated time, continue the treatment according to the prescribed dosage. Do not use a larger dose to compensate for the forgotten dose.

Adhere to the treatment as recommended by your doctor. In order to obtain the maximum benefit from the medicine, you must take it regularly, and consistently both during acute episodes of inflammation and as preventive treatment during remission.

Abrupt stopping of the medicine is not recommended.

Even if there is an improvement in your health condition, do not stop the treatment with the medicine without consulting your doctor.

Do not take or use medicines in the dark! Check the label and the dose each time you take a medicine.

Wear glasses if you need them.

If you have further questions concerning the use of the medicine, consult your doctor or pharmacist.

4. Side effects

As with any medicine, use of Rafassal enema may cause side effects in some users. Do not be alarmed while reading the list of side effects. You may not suffer from any of them.

Stop the treatment and contact a doctor immediately in the following cases:

- If an allergic reaction occurs. Any medicine can cause an allergic reaction although a serious allergic reaction is very rare. Symptoms of an allergic reaction may include: fever, skin rash, breathing difficulties.
- If you suffer from a generally unwell feeling (deterioration in your general health), especially if accompanied by fever and/or sore mouth and/or throat. These symptoms can, very rarely, indicate a fall in the number of white blood cells (agranulocytosis), a condition which may make you more prone to developing a serious infection. A blood test can confirm whether these symptoms are due to the effect of this medicine on your blood.
- If you notice any of the following symptoms: reddish non-elevated, target-like or circular patches, often with central blisters, skin peeling, ulcers of the mouth, throat, nose, genitals and eyes. These serious skin reactions can be preceded by fever and flu-like symptoms. See also 'Additional warnings' in section 2.

Additional side effects:

Rare side effects (appear in 1-10 users out of 10,000):

- Abdominal pain, diarrhea, wind (flatulence), nausea, vomiting, constipation.
- Headache, dizziness.
- Chest pain, breathlessness or swollen limbs because of an effect on the heart (including inflammation of the heart muscle or heart membrane).
- Photosensitivity, which is increased sensitivity of the skin to sun and ultraviolet (UV) light.

Very rare side effects (appear in less than 1 user out of 10,000):

- Changes in kidney functions, sometimes accompanied by swelling of the limbs or flank pain.
- Inflammation of the pancreas which can be manifested in severe abdominal pain.
- Fever, sore throat, malaise due to blood count changes.
- Allergic and/or inflammatory reaction of the lungs which can be manifested, inter alia, in shortness of breath, cough, wheezing, lung shadow seen on x-ray.
- Severe diarrhea and/or severe abdominal pain because of inflammation or an allergic reaction of the bowel.
- Skin rash or inflammation, lupus erythematosus syndrome.
- Muscle and/or joint pains.
- Liver and/or bile flow disorders which may cause abdominal pain and/or jaundice (which may be manifested in yellowing of the skin and the white of the eye).
- Liver function problems (including inflammation of the liver, increase in liver enzyme levels).
- Hair loss, development of baldness.
- Numbness and tingling in the hands and feet (peripheral neuropathy).
- Reversible decrease in semen production.

Side effects of unknown frequency (effects whose frequency has not yet been determined):

- Kidney stones and associated kidney pain (see also warnings in section 2).

If a side effect appears, if any of the side effects worsens, or you suffer from a side effect not mentioned in the leaflet, consult your doctor.

Side effects may be reported to the Ministry of Health by clicking on the link "Report on side effects following medicinal treatment" on the homepage of the Ministry of Health website (www.health.gov.it) which leads to an online form for reporting side effects, or by entering the link: <https://sideeffects.health.gov.it/>

5. How to store the medicine?

- Avoid poisoning! This medicine, and any other medicine, must be stored in a closed place out of the reach and sight of children and/or infants, to avoid poisoning. Do not induce vomiting unless explicitly instructed to do so by the doctor.
- Do not use the medicine after the expiry date (exp. date) stated on the package. The expiry date refers to the last day of that month.
- Storage conditions: store below 25°C.

6. Additional information

In addition to the active ingredient, the medicine also contains:

Potassium metabisulfite, potassium acetate, xantan gum, disodium edetate, sodium benzoate, carbomer 934P, purified water.

What does the medicine look like and what does the package contain?

Beige/light brown suspension, in squeeze bottle.

Each box contains 7 enemas of 60 gram each.

7 Instructions on how to use the enema:

The best results will be obtained if the enema is administered immediately after bowel emptying.

1) Preparation of the enema for use:

- a) Shake the bottle well to ensure homogeneity of the liquid.
- b) Remove the protective cap from the applicator and hold the bottle by its neck to prevent leakage (Figure 1).

2) Correct position of the body:

- a) The best results are achieved while lying on the left side, with the left leg straight and the right leg bent forward for balance (Figure 2a).
- b) Another option is: "knee-chest" position (Figure 2b).

3) Administration of the enema:

- a) Thoroughly clean and dry the rectal region (anus).
- b) Gently insert the applicator, which is already lubricated, into the anus (rectum) while directing it towards the navel.
- c) Hold the bottle firmly and tilt it slightly, so that the applicator tip is directed towards the back and then slowly squeeze the bottle to insert the liquid inside (Figure 3). Steady pressure of the hand will release most of the liquid. After use, discard the used bottle.
- d) Stay in this position for at least the next 30 minutes to enable complete spreading of the medicine in the intestine.

If possible, use the enema at bedtime and hold the liquid inside all night long.

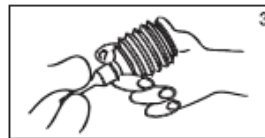
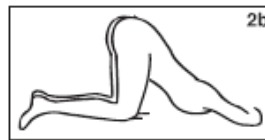
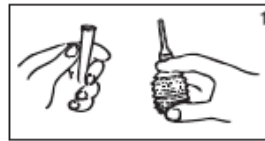

Registration holder: Rafa Laboratories Ltd., P.O. Box 405, Jerusalem 9100301.

Medicine registration number in the National Medicines Registry of the Ministry of Health:

Rafassal 1 gram Enema: 1203926001

Rafassal 4 gram Enema: 0295825321

Revised in July 2021 according to MOHs guidelines.

056007-I