

Veterinary medicine package leaflet

This medicine is dispensed with a veterinarian's prescription only
For use in animals only

1. Name, form and strength of the veterinary medicine

Eazi Breed CIDR G Veterinary, intravaginal insert

2. Active ingredient

Progesterone 0.35 g

List of the inactive ingredients in section 13.

3. What is this medicine intended for?

Estrus control in sheep

Induction of oestrus in sheep (ewes) during seasonal anoestrus; this is the period in which the sheep (ewes) do not have regular oestrus cycles outside the natural breeding season. Eazi Breed CIDR G Veterinary intravaginal insert has not been tested in oestrous cycling ewes.

Therapeutic group: Genito-urinary system and sex hormones.

ATCVet code: QG03DA04

4. Contraindications

Do not use in pregnant ewes.

Do not use in ewes with abnormal or immature or infected genital tracts.

5. Side effects

Local irritation and discharge of cloudy/yellow mucus are common and discharge of dark red, brown or bloody mucus is uncommon. However, these signs resolve on their own within 2 days of removal of the insert without the need for treatment.

You can report side effects to the Ministry of Health by following the link 'Reporting Side Effects of Drug Treatment' on the Ministry of Health home page (www.health.gov.il) which links to an online form for reporting side effects. You can also use this link: <https://sideeffects.health.gov.il>.

6. Target animals

Sheep (ewes)

7. Route of administration and dose

For induction of oestrus in ewes (sheep) during seasonal anoestrus:

Administer the Eazi Breed CIDR G Veterinary insert into each female for a 5-day period. After insert removal, use standard sheep breeding procedures to breed the ewes during the induced oestrus period.

8. How to use this medicine

Administration of the insert: Wear protective gloves to prevent the insert from coming into contact with the skin.

1. Use specially designed Eazi Breed CIDR G Veterinary applicator to administer the insert.
2. Restrain ewes appropriately prior to administration.
3. Wash the applicator in a non-irritating antiseptic solution, and then apply a veterinary lubricant to the end of the applicator.
4. Insert the tail end of the Eazi Breed CIDR G Veterinary insert into the applicator. Make sure that the tail extends upward through the slot of the applicator and is pointed away from the handle.
5. Fold the wings of the Eazi Breed CIDR G Veterinary insert to make it longer and continue to insert it into the applicator until it is fully inserted, with only the tips of the wings protruding from the end of the applicator (Figure 1).
6. Lubricate the protruding tips of the wings of Eazi Breed CIDR G Veterinary with veterinary lubricant.
7. Clean the exterior of the vulva with disposable wipes.
8. Open the lips of the vulva and gently insert the applicator. The slot in the applicator should face down (Figure 2).
9. Once the loaded applicator is inside the vagina, slope the applicator slightly upwards (35°-45° angle) by lowering the handle, and then continue without forcing, until the applicator is fully inserted or resistance is felt (Figure 3).
10. Squeeze the finger grips within the handle of the applicator to release the Eazi Breed CIDR G Veterinary insert into the vagina (Figure 4) and then pull the applicator backwards and remove it from the vagina.
11. When the Eazi Breed CIDR G Veterinary is correctly placed, with the wings open in the anterior portion of the vagina, the tail of the insert should protrude from the animal's vagina.

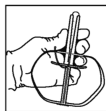

Figure 1



Figure 2



Figure 3

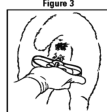

Figure 4

Removal of the device:

1. To remove the Eazi Breed CIDR G Veterinary insert, pull gently but firmly on the protruding nylon tail.
2. The Eazi Breed CIDR G Veterinary insert may change direction within the vagina; therefore, if the nylon tail is not protruding on the day of removal of the device, check the vagina to ensure that the insert is present.

9. Withdrawal period

Meat: 0 days

Milk: 0 hours

10. Warnings

• Special warnings about treating the target animal with this medicine

The efficacy and safety of the medicine has not been evaluated in ewes which are unwell, which have a BCS <2 or ≥4, which have had complications during previous pregnancies or lambings, or which have lambed within the last 45 days.

Use only according to the benefit/risk assessment by the responsible veterinarian.

Animals in poor condition, whether from illness, inadequate nutrition, or other factors, may respond poorly to treatment.

- **Special safety precautions for the person administering the medicine**
Progesterone is a potent steroid hormone and may cause side effects on the reproductive system in cases of high or prolonged exposure. Adverse effects on unborn children cannot be ruled out. The product may cause skin and eye irritation, as well as allergic skin rashes.
Those administering the product should avoid contact with the silicone section of the insert. Pregnant women should avoid contact with the product completely.
Wear protective gloves when administering and removing the product. Administer the insert using the applicator. Wash hands and exposed skin with soap and water after contact with the product.
Do not smoke, eat or drink while handling the product.
- **Pregnancy and lactation**
Do not use in pregnant ewes. The safety of the veterinary product has not been established in lactating animals. Use only according to the benefit/risk assessment by the responsible veterinarian.
- **Drug interactions**
None known.
- **Overdose**
Not applicable
- **Incompatibility**
Not applicable

11. Storage instructions

- Prevent poisoning! To prevent poisoning, keep this and all other medicines, in a closed place, out of the reach and sight of children and/or infants.
- Do not use the medicine after the expiry date (exp. date) which is stated on the package. The expiry date refers to the last day of that month.
- Store below 25°C.

12. Instructions for the disposal of the unused product or waste materials

A used Eazi Breed CIDR G Veterinary insert contains a certain amount of progesterone. Keep the used insert in a closed container until destruction. Dispose of any remaining veterinary medicine or waste obtained from using a veterinary medicine in the same manner as toxic waste; do not discard into a sewer.

13. Additional information

- **In addition to the active ingredient, this medicine also contains**
Liquid Silicon Rubber
Nylon Spine
- **What the medicine looks like and contents of the pack**
The package of medicine contains 20 Eazi Breed CIDR G Veterinary inserts per bag. Each insert is moulded silicone over a flexible nylon spine. Attached to each Eazi Breed CIDR G Veterinary insert is a nylon tail.
- **Registration holder**
Zoetis Israel Holding B.V., 5 Atir Yeda st., Kfar Saba
- **Manufacturer's name:**
DEC International New Zealand LTD., 558 Te Rapa Rd. Hamilton 3241, New Zealand
- **Registration number of the medicine in the Ministry of Health's National Drug Registry**
083-62-91947-00

Revised in December 2021 according to MOH guidelines.