

USER MANUAL KwikPen pre-filled insulin pen

100 units/ml



PLEASE READ THIS USER MANUAL BEFORE USE

Read the User Manual before you start taking your insulin and each time you get another KwikPen. There may be new information. This information does not take the place of talking to your healthcare professional about your medical condition or your treatment.

KwikPen (“Pen”) is a disposable pre-filled pen containing 3 ml (300 units, 100 units/ml) of insulin. You can give yourself multiple doses using one Pen. The Pen dials 1 unit at a time. You can give from 1 to 60 units in a single injection. **If your dose is more than 60 units, you will need to give yourself more than one injection.** The plunger only moves a little with each injection, and you may not notice that it moves. The plunger will only reach the end of the cartridge when you have used all 300 units in the Pen.

Do not share your pen with other people, even if the needle has been changed. Do not reuse or share needles with other people. You may give an infection to them or get an infection from them.

This Pen is not recommended for use by the blind or visually impaired without the help of someone trained to use the Pen.

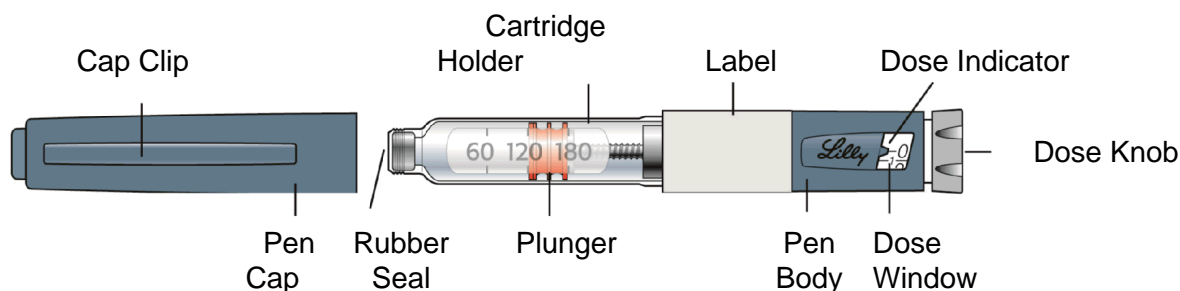

KwikPen Parts

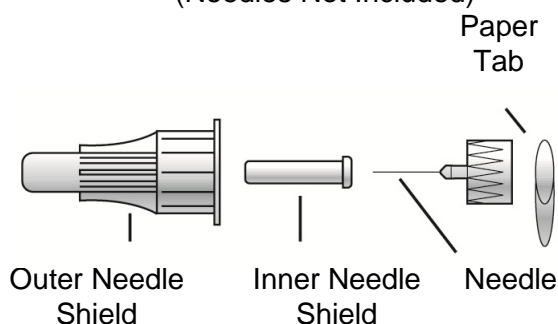

Pen Needle Parts
(Needles Not Included)



How to recognize your KwikPen:

	Humalog Solution	Humalog Mix 25 Suspension (cloudy insulin)	Humalog Mix 50 Suspension (cloudy insulin)
Pen color:	Blue	Blue	Blue
Dose Knob:	 Burgundy	 Yellow	 Red
Labels:	White with Burgundy Color Bar	White with Yellow Color Bar	White with Red Color Bar

Supplies needed to give your injection:

- KwikPen containing your insulin
 - KwikPen compatible Needle (BD [Becton, Dickinson and Company] Pen Needles recommended)
 - Swab
- Needles and swab are not included.

Preparing your Pen

- Wash your hands with soap and water.
- Check the Pen to make sure you are taking the right type of insulin. This is especially important if you use more than 1 type of insulin.
- **Do not** use your Pen past the expiration date printed on the Label. After you start using the Pen, throw your Pen away after the in-use time specified in the Patient Leaflet.
- Always use a **new Needle** for each injection to help prevent infections and blocked Needles.

Step 1:

- Pull the Pen Cap straight off.
 - **Do not** remove the Pen Label.
- Wipe the Rubber Seal with a swab.

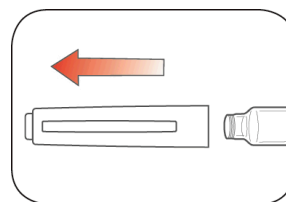

Step 2:

(For Humalog suspensions cloudy insulins only)

- Gently roll the Pen 10 times.
- AND
- Invert the Pen 10 times.

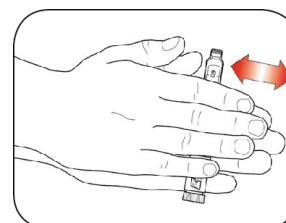

Mixing is important to make sure you get the right dose. The insulin should look evenly mixed.

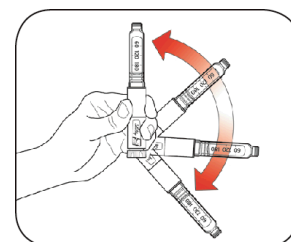

Step 3:

- Check the appearance of the insulin.
 - The **Humalog** solution should look clear and colorless. Do not use if it is cloudy, colored, or has particles or clumps in it.
 - **Humalog** suspensions - cloudy insulins - should look white after mixing. **Do not** use if it looks clear or contains any clumps or particles.

Step 4:

- Select a new Needle.
- Pull off the Paper Tab from the Outer Needle Shield.

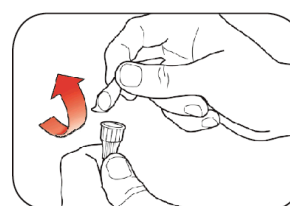

Step 5:

- Push the capped Needle straight onto the Pen and twist the Needle on until it is tight.

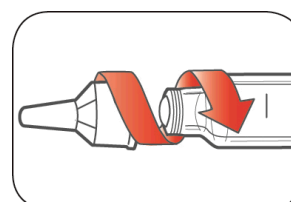

Step 6:

- Pull off the Outer Needle Shield. **Do not** throw it away.
- Pull off the Inner Needle Shield and throw it away.

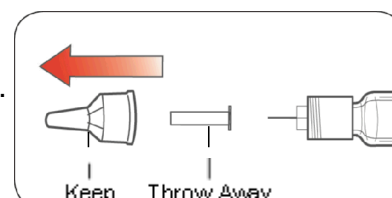

Priming your Pen

Prime before each injection.

- Priming your Pen means removing the air from the Needle and Cartridge that may collect during normal use and ensures that the Pen is working correctly.
- If you **do not** prime before each injection, you may get too much or too little insulin.

Step 7:

- To prime your Pen, turn the Dose Knob to select 2 units.

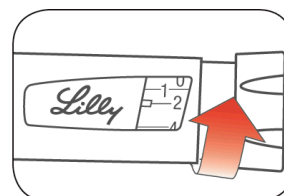

Step 8:

- Hold your Pen with the Needle pointing up. Tap the Cartridge Holder gently to collect air bubbles at the top

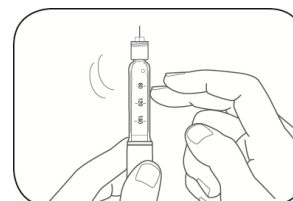

Step 9:

- Continue holding your Pen with Needle pointing up. Push the Dose Knob in until it stops, and "0" is seen in the Dose Window. Hold the Dose Knob in and count to 5 slowly.

You should see insulin at the tip of the Needle.

- If you **do not** see insulin, repeat the priming steps, but not more than 4 times.
- If you **still do not** see insulin, change the Needle and repeat the priming steps.

Small air bubbles are normal and will not affect your dose.

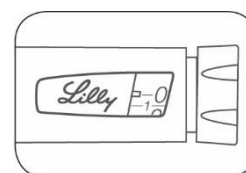
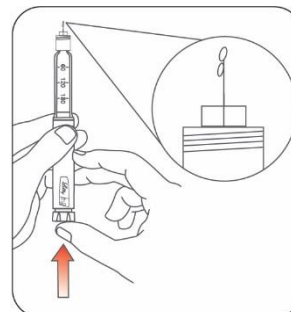

Selecting your dose

- You can give from 1 to 60 units in a single injection.
- If your dose is more than 60 units, you will need to give more than one injection.
 - If you need help deciding how to divide up your dose, ask your healthcare professional.
 - You should use a new Needle for each injection and repeat the priming step.

Step 10:

- Turn the Dose Knob to select the number of units you need to inject. The Dose Indicator should line up with your dose.
 - The Pen dials 1 unit at a time.
 - The Dose Knob clicks as you turn it.
 - **DO NOT** dial your dose by counting the clicks because you may dial the wrong dose.
 - The dose can be corrected by turning the Dose Knob in either direction until the correct dose lines up with the Dose Indicator.
 - The even numbers are printed on the dial.
 - The odd numbers, after the number 1, are shown as full lines.

- **Always check the number in the Dose Window to make sure you have dialled the correct dose.**

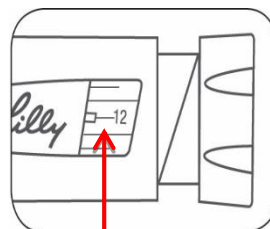
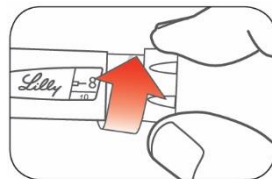

(Example: 12 units shown in the Dose Window)

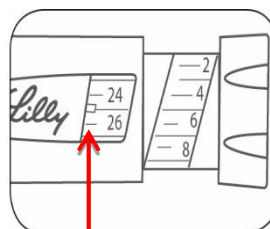

(Example: 25 units shown in the Dose Window)

- The Pen will not let you dial more than the number of units left in the Pen.
- If you need to inject more than the number of units left in the Pen, you may either:
 - inject the amount left in your Pen and then use a new Pen to give the rest of your dose, **or**
 - get a new Pen and inject the full dose.
- It is normal to see a small amount of insulin left in the Pen that you cannot inject.

Giving your injection

- Inject your insulin as your healthcare professional has shown you.
- Change (rotate) your injection site for each injection.
- **Do not** try to change your dose while injecting.

Step 11:

- Choose your injection site.
Your insulin is injected under the skin (subcutaneously) of your stomach area, buttocks, upper legs or upper arms.
- Wipe your skin with a swab, and let the injection site dry before you inject your dose.

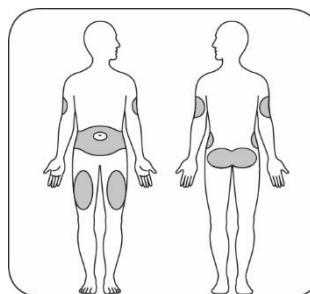

Step 12:

- Insert the Needle into your skin.
- Push the Dose Knob all the way in.
- Continue to hold the Dose Knob in and **slowly count to 5** before removing the Needle.

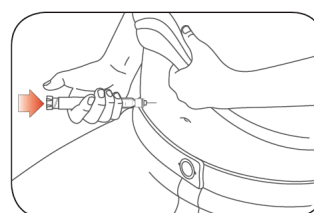

Do not try to inject your insulin by turning the Dose Knob. You will **NOT** receive your insulin by turning the Dose Knob.

Step 13:

- Pull the Needle out of your skin.
 - A drop of insulin at the Needle tip is normal. It will not affect your dose.
- Check the number in the Dose Window
 - If you see “0” in the Dose window, you have received the full amount you dialled.
 - If you do not see “0” in the Dose window, do not redial. Insert the needle into your skin and finish your injection.
 - If you **still** do not think you received the full amount you dialled for your injection, **do not start over or repeat that injection.** Monitor your blood glucose as instructed by your healthcare professional.

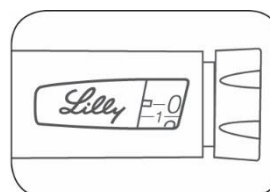

- If you normally need to give 2 injections for your full dose, be sure to give your second injection.

The plunger only moves a little with each injection, and you may not notice that it moves.

If you see blood after you take the Needle out of your skin, press the injection site lightly with a piece of gauze or a swab. **Do not** rub the area.

After your injection

Step 14:

- Carefully replace the Outer Needle Shield.

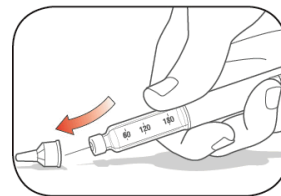

Step 15:

- Unscrew the capped Needle and dispose of it as described below (see **Disposing of Pens and Needles** section).
- Do not store the Pen with the Needle attached to prevent leaking, blocking the Needle, and air from entering the Pen.

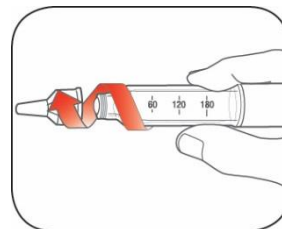

Step 16:

- Replace the Pen Cap by lining up the Cap Clip with the Dose Indicator and pushing straight on.

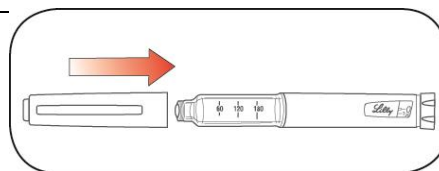

Disposing of pens and needles

- Put used Needles in a sharps container or a hard plastic container with a secure lid. **Do not** throw needles directly into your household waste.
- **Do not** recycle the filled sharps container.
- Ask your healthcare professional about options to dispose of the Pen and the sharps

- container properly.
- The directions regarding needle handling are not intended to replace local, healthcare professional or institutional policies.

Storing your pen

Unused pens

- Store unused Pens in the refrigerator at 2°C to 8°C.
- **Do not** freeze your insulin. **Do not** use if it has been frozen.
- Unused Pens may be used until the expiration date printed on the Label, if the Pen has been kept in the refrigerator.

In-use Pen

- Store the Pen you are currently using at room temperature up to 30°C and away from dust, food and liquids, heat and light.
- Throw away the Pen you are using after the time specified in the Patient Leaflet, even if it still has insulin left in it.

General information about the safe and effective use of your pen

- **Keep your Pen and Needles out of the sight and reach of children.**
- **Do not** use your Pen if any part looks broken or damaged.
- Always carry an extra Pen in case yours is lost or damaged.

Troubleshooting

- If you cannot remove the Pen Cap, gently twist the cap back and forth, and then pull the cap straight off.
- If the Dose Knob is hard to push:
 - Pushing the Dose Knob more slowly will make it easier to inject.
 - Your Needle may be blocked. Put on a new Needle and prime the Pen.
 - You may have dust, food, or liquid inside the Pen. Throw the Pen away and get a new Pen. You may need to get a prescription from your healthcare professional.

If you have any questions or problems with your KwikPen, contact your healthcare professional for assistance.

Humalog®, Humalog® KwikPen™, Humalog® Mix 50™ KwikPen™ and Humalog® Mix 25™ KwikPen™ are trademarks of Eli Lilly and Company.

Copyright © 2016, Eli Lilly and Company. All rights reserved.

KwikPen meets the current dose accuracy and functional requirements of ISO 11608-1
--

Manufacturer: Eli Lilly & Company Ltd., Indianapolis, Indiana, USA

License holder: Eli Lilly Israel Ltd., P.O.B. 2160, Herzliya Pituach 4672511

This leaflet was reviewed and approved by the Ministry of Health in June 2015 and updated according to the guidelines of the Ministry of Health in December 2019.